

Operator's Manual

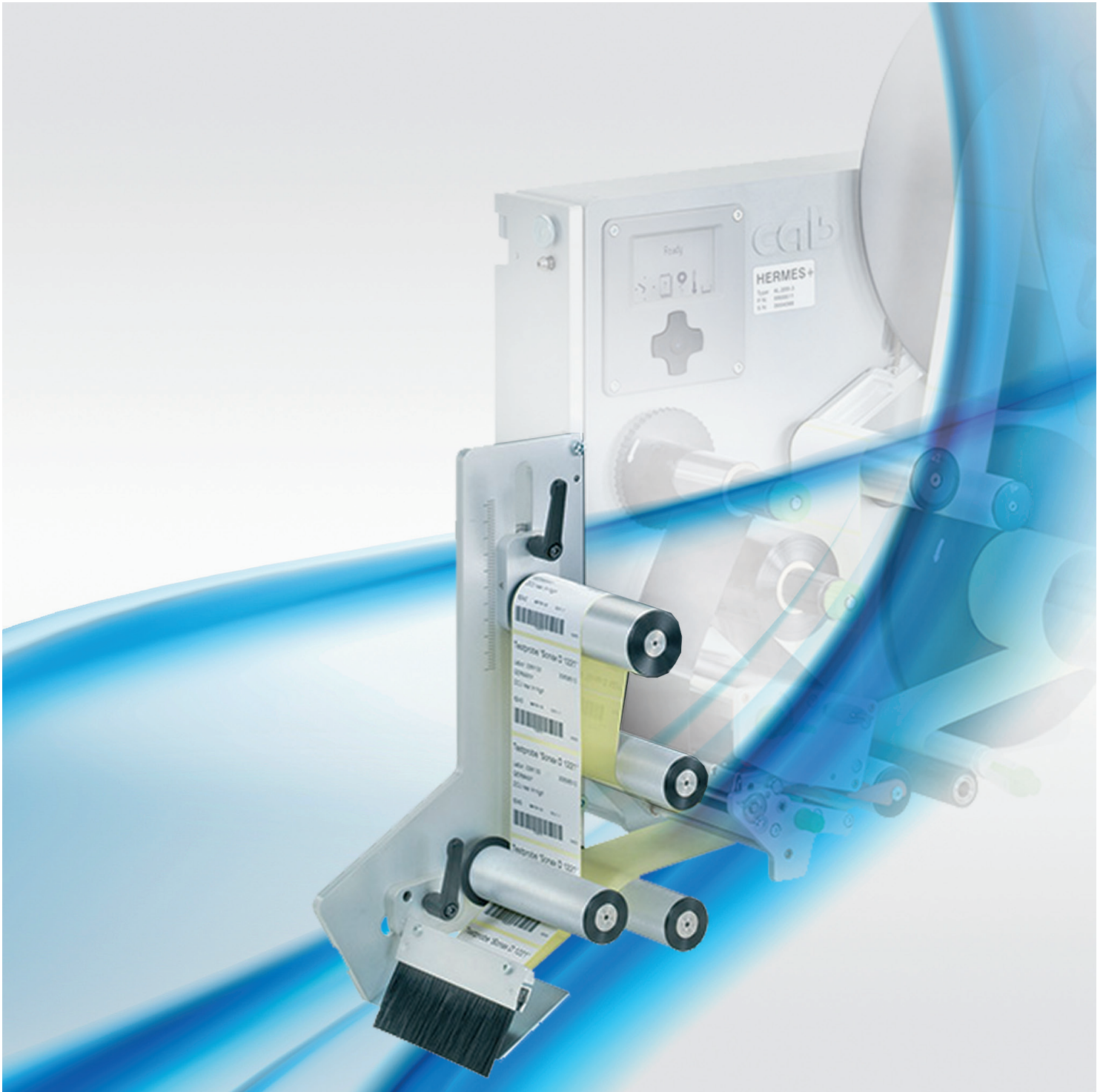

Demand Module

5114 / 5116

Made in Germany

Description	Type
Demand Module	5114-L
	5114-R
	5116-L
	5116-R

Edition: 08/2017 - Part No. 9009059

Copyright

This documentation as well as translation hereof are property of cab Produkttechnik GmbH & Co. KG.

The replication, conversion, duplication or divulgement of the whole manual or parts of it for other intentions than its original intended purpose demand the previous written authorization by cab.

Editor

Regarding questions or comments please contact cab Produkttechnik GmbH & Co. KG.

Topicality

Due to the constant further development of our products discrepancies between documentation and product can occur. Please check www.cab.de for the latest update.

Terms and conditions

Deliveries and performances are effected under the General conditions of sale of cab.

Germany

cab Produkttechnik
GmbH & Co KG
Postfach 1904
D-76007 Karlsruhe
Wilhelm-Schickard-Str. 14
D-76131 Karlsruhe
Telefon +49 721 6626-0
Telefax +49 721 6626-249
www.cab.de
info@cab.de

France

cab technologies s.a.r.l.
F-67350 Niedermodern
Téléphone +33 388 722 501
www.cab.de/fr
info.fr@cab.de

USA

cab Technology Inc.
Tyngsboro MA, 01879
Phone +1 978 649 0293
www.cab.de/us
info.us@cab.de

Asia 亚洲

cab Technology Co., Ltd.
希愛比科技股份有限公司
Junghe, Taipei, Taiwan
Phone +886 2 8227 3966
www.cab.de/tw
info.asia@cab.de

China 中国

cab (Shanghai) Trading Co., Ltd.
铠博(上海)贸易有限公司
Phone +86 21 6236-3161
www.cab.de/cn
info.cn@cab.de

Representatives in other countries on request

1	Introduction	4
1.1	Instructions	4
1.2	Intended Use	4
1.3	Safety Instructions.....	4
1.4	Environment	5
2	Product Description.....	6
2.1	Function	6
2.2	Technical Data.....	6
2.3	Contents of Delivery.....	6
2.4	Device Overview	7
3	Installation	8
3.1	Connecting the Signal Generator with Printer.....	8
3.2	Mounting the Demand Module on Printer	8
3.3	Loading Material.....	9
4	Adjustments	10
4.1	Alignment of the Demand Module to the Printer	10
4.2	Adjusting The Labelling Position	11
5	Operation	11
6	EU Declaration of Conformity	12

1.1 Instructions

Important information and instructions in this documentation are designated as follows:



Danger!

Draws attention to an exceptionally great, imminent danger to your health or life due to hazardous voltages.



Danger!

Draws attention to a danger with high risk which, if not avoided, may result in death or serious injury.



Warning!

Draws attention to a danger with medium risk which, if not avoided, may result in death or serious injury.



Caution!

Draws attention to a danger with low risk which, if not avoided, may result in minor or moderate injury.



Attention!

Draws attention to potential risks of property damage or loss of quality.



Note!

Advice to make work routine easier or on important steps to be carried out.



Environment!

Gives you tips on protecting the environment.



Handling instruction



Reference to section, position, illustration number or document.



Option (accessories, peripheral equipment, special fittings).

Time Information in the display.

1.2 Intended Use

- The device is manufactured in accordance with the current technological status and the recognized safety rules. However, danger to life and limb of the user or third parties and/or damage to the device and other tangible assets can arise during use.
- The device may only be used for its intended purpose and if it is in perfect working order, and it must be used with regard to safety and dangers as stated in the operating manual.
- The device applicator mounted on a cab printer of the Hermes+ series is intended exclusively for applying suitable materials that have been approved by the manufacturer. Any other use or use going beyond this shall be regarded as improper use. The manufacturer/supplier shall not be liable for damage resulting from unauthorized use; the user shall bear the risk alone.
- Usage for the intended purpose also includes complying with the operating manual, including the manufacturer's maintenance recommendations and specifications.



Note!

The complete and current version of the documentation can be found in the Internet.

1.3 Safety Instructions



Attention!

Initiation, adjustments and changing of parts are to be performed by qualified service personnel only.



Warning!

This is a class A product. In a domestic environment this product may cause radio interference in which case the user may be required to take adequate measures.

- The device may only be used in a dry environment, do not expose it to moisture (sprays of water, mists, etc.)

1.4 Environment



Obsolete devices contain valuable recyclable materials that should be sent for recycling.

- Send to suitable collection points, separately from residual waste.

The modular construction of the applicator enables it to be easily disassembled into its component parts.

- Send the parts for recycling.

2.1 Function

The Demand Module 5114-L/R or 5116-L/R is a mechanical device to be used in combination with a printer of the Hermes+ series.

The Demand Module is developed to be integrated within a system in a production line. The label will be applied on the product via a dispensing module. The label will be applied on the product with a brush. The Demand Module relies on an external start signal to commence operation.

2.2 Technical Data

Technical data		Demand module 5114-L/R	Demand module 5116-L/R
Label width	mm	25 - 114	50 - 174
Label height	mm	25 - 250	
Distance from print line to peel-off plate	mm	400-600	
Product in motion during labeling	moving	■	
Labeling onto the product	from top	■	
	from below	■	
	from the side	■	
Product height	fixed	■	
Product distance to lower edge	mm	80	
Product speed		in relation to the print speed	
Cycle time ¹⁾	approx. cycles/min	60	

¹⁾ Label height 100 mm, print speed 100 mm/s

Table 1 Technical data

2.3 Contents of Delivery

- Check the Demand Module for damage that may have occurred during transit.

Contents of delivery:

- Demand module 5114-L/R or 5116-L/R
- Documentation



Note!

Please keep the original packaging in case the applicator needs to be returned.

2.4 Device Overview

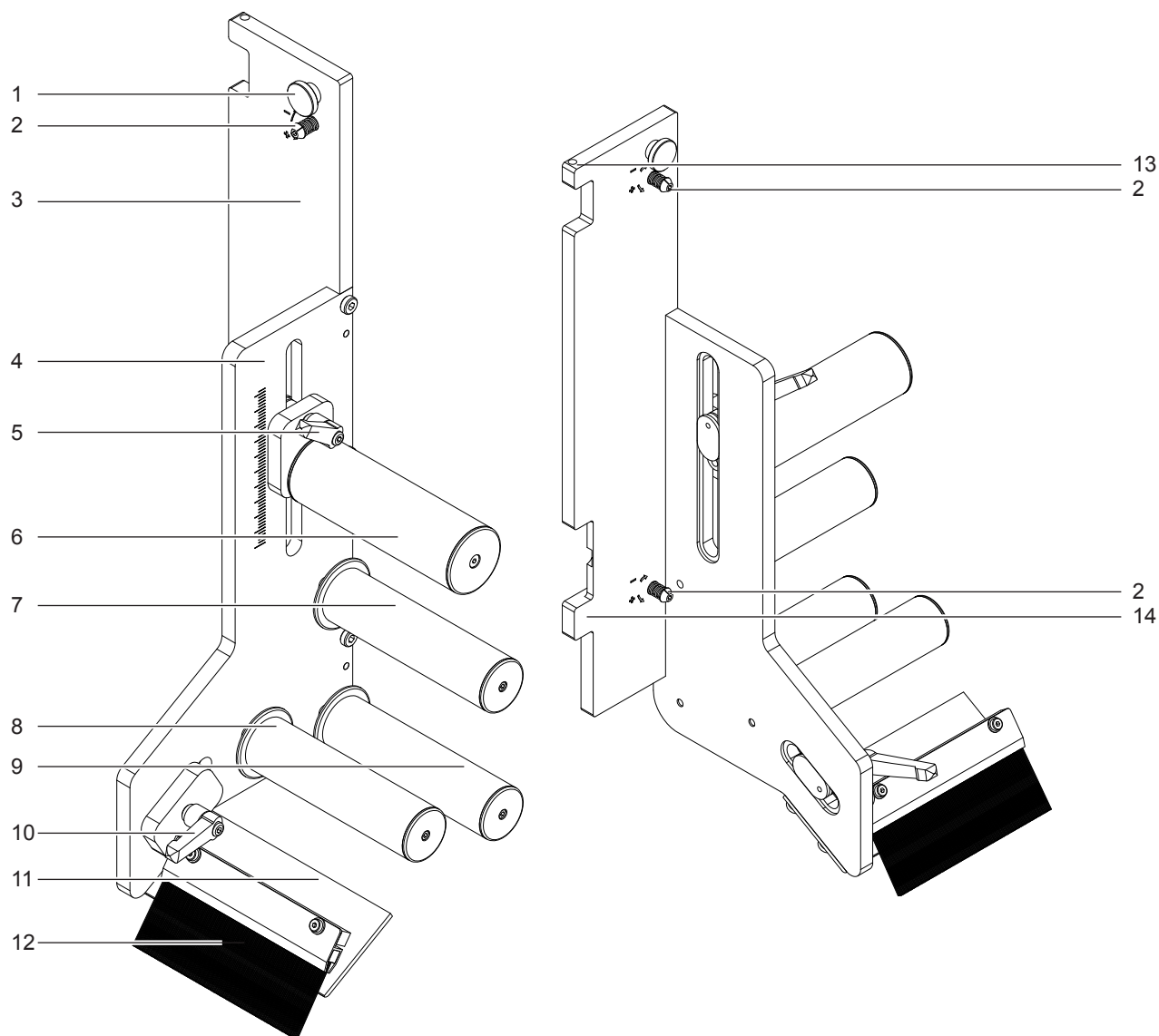

Fig. 1 Device overview

- | | | | |
|---|----------------------------------|----|-------------------------|
| 1 | Screw M5 | 8 | Reverse Roll C |
| 2 | Set Screw | 9 | Reverse Roll D |
| 3 | Mounting Plate | 10 | Locking Lever for Brush |
| 4 | Base Plate | 11 | Dispense Plate |
| 5 | Locking Lever for Reverse Roll B | 12 | Brush |
| 6 | Reverse Roll B | 13 | Hinges top |
| 7 | Reverse Roll A | 14 | Hinges bottom |

3.1 Connecting the Signal Generator with Printer

The operation of the printer with a Demand Module requires an external start signal.

- ▶ Connect a signal generator like the cab product sensor PLC for an external start signal on printer.
 - ▷ Operator's Manual of the Hermes+

3.2 Mounting the Demand Module on Printer

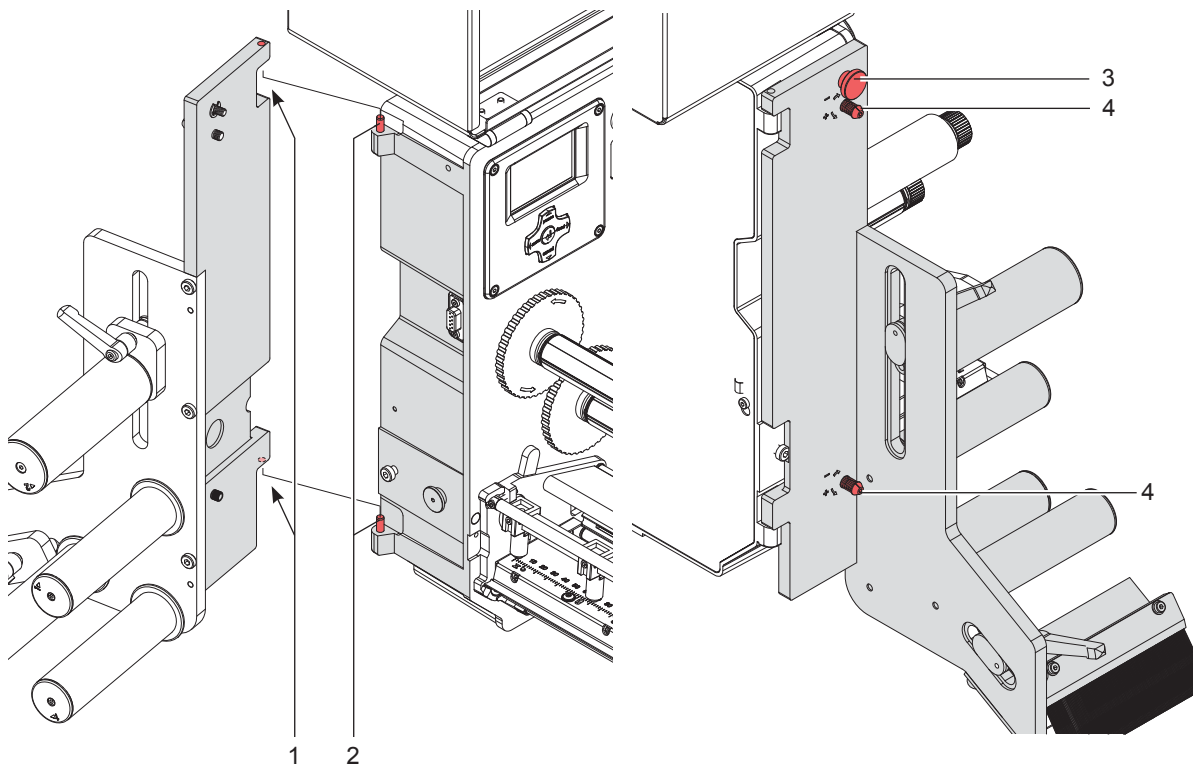

Fig. 2 Mounting the Demand Module

1. With the female hinges (1) hang the Demand Module onto the male hinges (2) of the printer.
2. Swing the Demand Module toward the printer and lock down to the printer it with screw (3).
3. Adjustments are performed with set screw (4). ▷ Chapter Adjustments

3.3 Loading Material

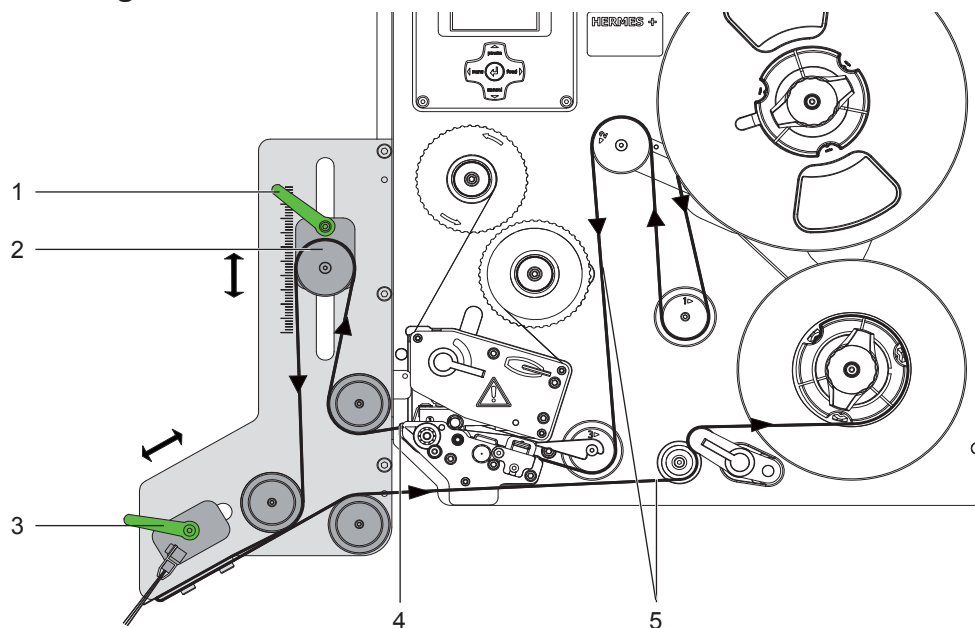

Fig. 3 Material flow of the printer and the Demand Module L

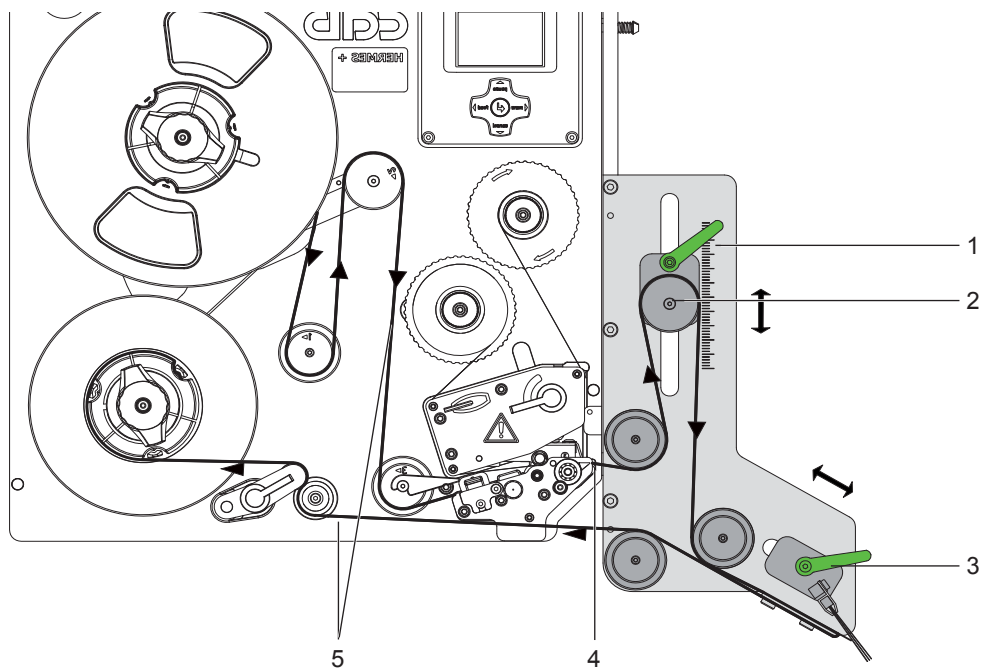

Fig. 4 Material flow of the printer and the Demand Module R

1. Feed the material, as illustrated, all the way to the dispensing plate (4).
2. If the label size needs to be changed use the reverse roller (2) and push it to the highest position. Turn the locking lever (1) counterclockwise to unlock the reverse roller (2).

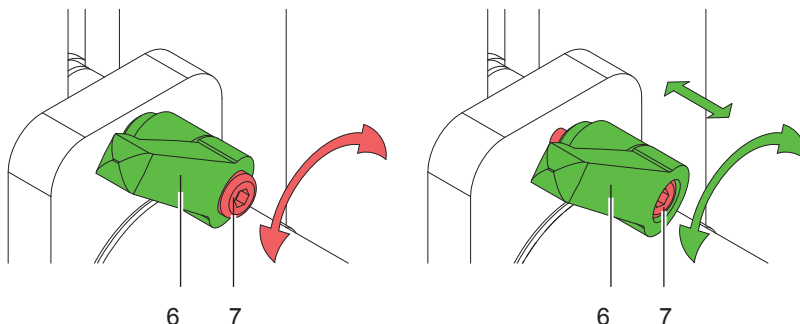

Fig. 5 Locking lever



Note!

If the clamp cannot be loosened enough the lever (6) can be pulled outward, as illustrated, and turned without turning the screw (7). If the lever released and snaps back into place the screw can be turned again.

This applies for lever 1 and 3 of figures 3 and 4.

3. Pull enough backing material off the roll, about 1m.
4. Remove all labels from the backing that has been pulled off the roller.
5. Guide the material (5) through the dispenser as displayed in Fig. 3/4.
6. Place the end of the backing material onto the rewinder of the printer as shown in the Operator's Manual (5) of the printer.

4 Adjustments

4.1 Alignment of the Demand Module to the Printer

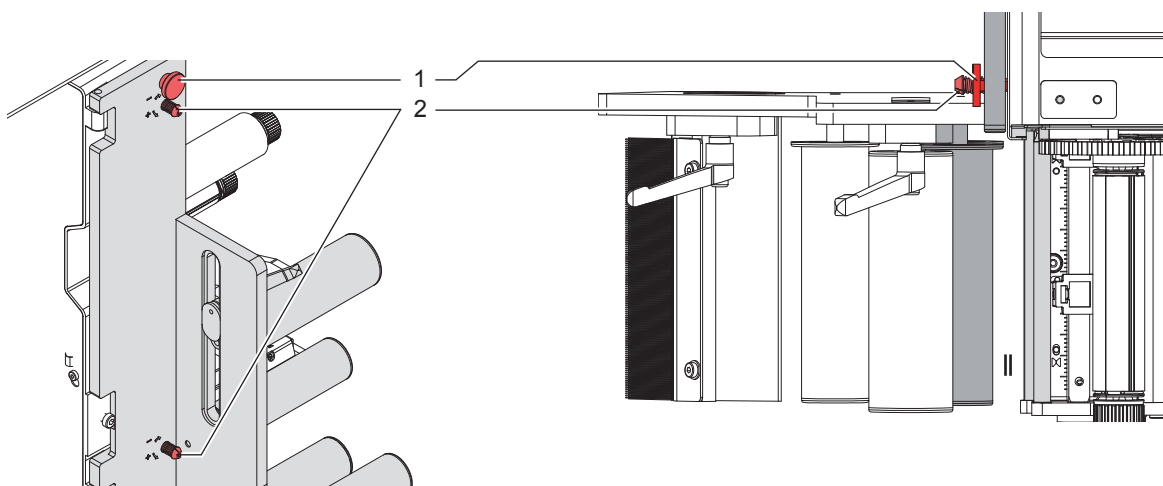

Fig. 6 Adjust demand module to the printer

1. Loosen screw (1).
2. Press demand module against the printer and turn set screw (2) so that the rolls of the demand module are parallel to the dispenser plate of the printer.
3. Tighten screw (1).

4.2 Adjusting The Labelling Position

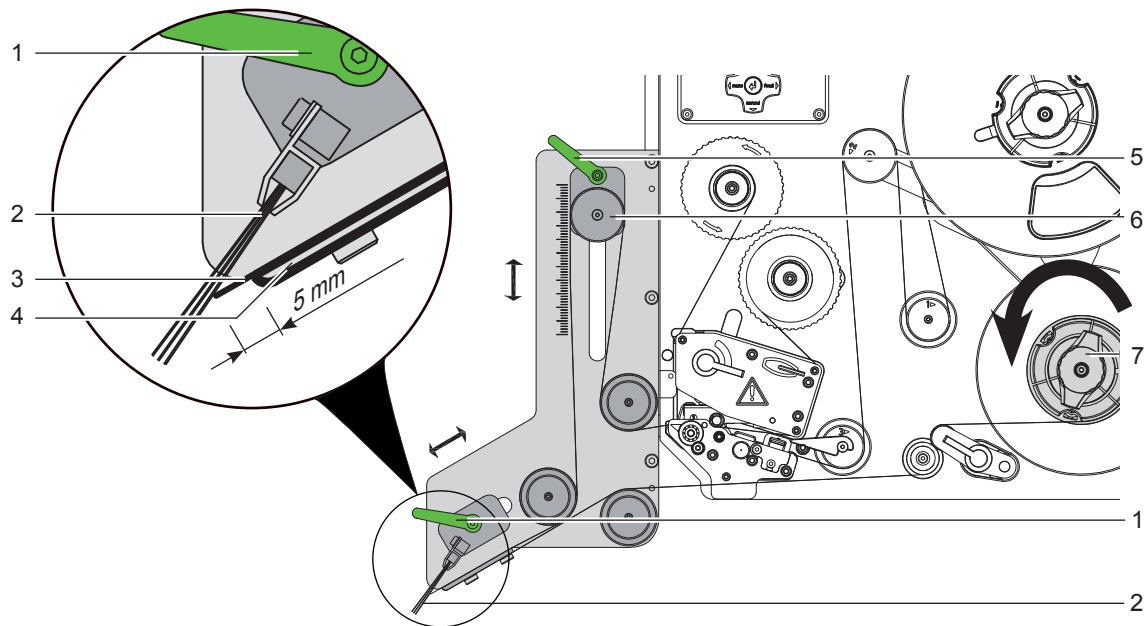

Fig. 7 Labelling position

1. Once the material has been loaded press the FEED button on navigator pad of the printer until a label is over the dispensing edge (4) of the Demand Module.
2. Turn the locking lever (5) counterclockwise to move the redirection roller (6) down carefully while turning the internal rewinder (7) of the printer to tense the material. Continue until the label is about 5 mm over the dispensing edge (4) as well as the printing edge.
3. Lock the redirection roller (6) by turning the lever (5) clockwise.
4. The position of the brush (2) can be altered by loosening the locking lever (1) counterclockwise. The adjustment should take into account the labeling material and surface of the product. Aligning the brush against the direction of labeling will increase the pressure onto the product.
5. Tighten the brush (2) by turning the locking lever clockwise.

5 Operation

1. Parameters of the printer
Setup > Machine Parameter > I/O signals > Mode Start **set on** Edge
2. Send print job.

**Note!**

Don't use the dispense mode of the printer in case of using the demand module.

▷ **Operator's Manual Hermes+**

3. Initiate print jobs via the signal generator until the first printed label has reached the dispensing plate of the Demand Module.
4. Start of the normal print and labelling operation.



cab Produkttechnik
GmbH & Co KG
Wilhelm-Schickard-Str. 14
D-76131 Karlsruhe
Germany

EU Declaration of Conformity

We declare herewith that as a result of the manner in which the device designated below was designed, the type of construction and the devices which, as a result have been brought on to the general market comply with the relevant fundamental regulations of the EU Rules for Safety and Health. In the event of any alteration which has not been approved by us being made to any device as designated below, this statement shall thereby be made invalid.

Device:	Demand Module
Interchangeable equipment for:	Hermes+
Type:	5114, 5116
Applied EU Regulations:	Applied Standards
Directive 2006/42/EG on Machines:	<ul style="list-style-type: none"> • EN ISO 12100: 2010 • EN ISO 13857: 2008
Signed for, and on behalf of the Manufacturer:	Sömmerda, 19.06.2017
cab Produkttechnik Sömmerda Gesellschaft für Computer- und Automationsbausteine mbH 99610 Sömmerda	 Erwin Fascher Managing Director